

Bookeye® 5

A2+ Book Scanner

*The production scanner for
challenging digitization projects*

V2A Automatic

Next Generation!



***Gentle document digitization paired
with maximum productivity thanks to
the motorized V-shaped glass plate***

**Image
Access**

© 07_2023 / EN



- COLOR OVERHEAD BOOK SCANNER
- SCAN AREA 14% MORE THAN DIN/ISO A2
- TRUE SCAN TECHNOLOGY, NOT A DIGICAM SUBSTITUTE
- FADGI, METAMORFOZE, ISO 19264-1 COMPLIANT
- 600 x 600 DPI SCANNER RESOLUTION
- 0.9 SEC FOR A2+ SCAN
- V-SHAPED MAGNETICALLY COUPLED BOOK CRADLE OPENS 120° OR 180°
- MOTOR DRIVEN V-SHAPED GLASS PLATE FOR PERFECT SCANS
- LASER ASSISTED BOOK FOLD CORRECTION
- AUTOMATIC FINGER REMOVAL
- SCAN-CLIENT INTERFACE
- AUTOMATIC CROP AND DESKEW
- VIRUS PROTECTED 64BIT LINUX OPERATING SYSTEM
- INTEL CORE I3 GEN.8 240GB SSD, 8GB RAM
- GIGABIT TCP/IP NETWORK INTERFACE
- LARGE 21" FULL HD MULTITOUCH FOR SIMPLIFIED OPERATION
- VIRTUAL RESCAN, MODIFY WITHOUT RESCANING
- EASY 3 BUTTON ACCESS START, SCAN, SEND
- 2 x USB 3.0 PORTS ACCESSIBLE ON FRONT PANEL
- EASY INSTALLATION VIA SCAN2NET® TECHNOLOGY

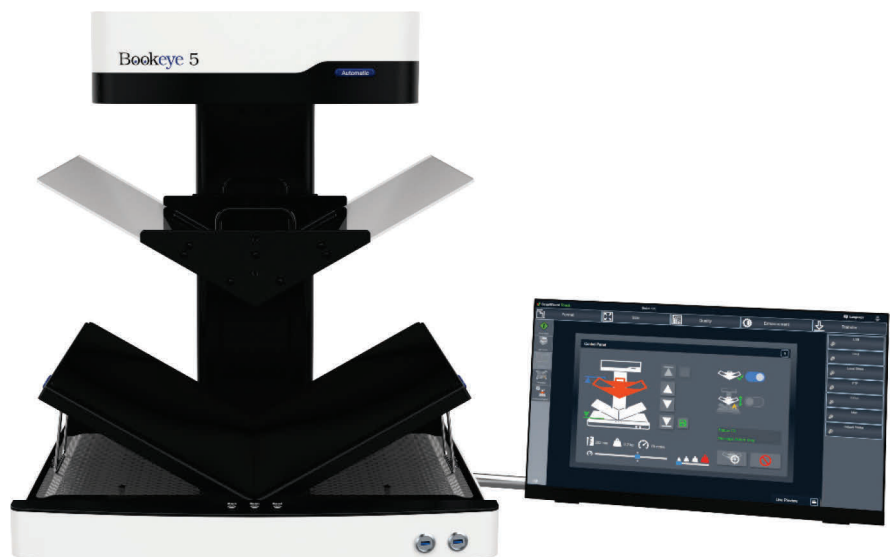

The Bookeye® 5 V3A Automatic book scanner is the latest model in Image Access' 5th generation of book scanners. Completely redesigned to meet the latest technological standards and to comply with the strictest environmental standards, it offers unsurpassed image quality paired with simple operation, a modern design, and literally maintenance-free operation for all professional applications.

A special highlight: the new, motor-driven V-shaped glass plate, which ensures very gentle digitization of books, magazines, posters, folders, or bound documents of all kinds.

PRODUCTIVITY MEETS QUALITY IN DIGITIZATION!

Bookeye® 5 V2A Automatic

Gentle document digitization paired with maximum productivity thanks to the motorized V-shaped glass plate

With its 600 dpi and a scan time of less than 3 seconds for the entire A2+ capture area, the latest model in Image Access' 5th generation of book scanners is equally suitable for large and small digitization projects.

A special highlight: the new, motor-driven V-shaped glass plate for maximum productivity

Automatically traversing at speeds from 19mm/sec up to 113mm/sec and a total stroke of 25cm, it gently presses flattens originals using the V-shaped cradle. The contact pressure can be individually adjusted, guaranteeing the gentlest handling of originals and distortion-free scans. Like all other Image Access Bookeye book scanners, the book cradle can also be used in flat mode.

The V-shaped glass plate is controlled via the ScanWizard's extended user interface. The new control panel with animated function buttons allows, among other things, horizontal movement up and down, setting the speed or the position in which the glass plate remains after the finished scan job. It does not necessarily have to be at the top or bottom. Depending on requirements, the glass plate can be removed and refitted without tools and in two simple steps.

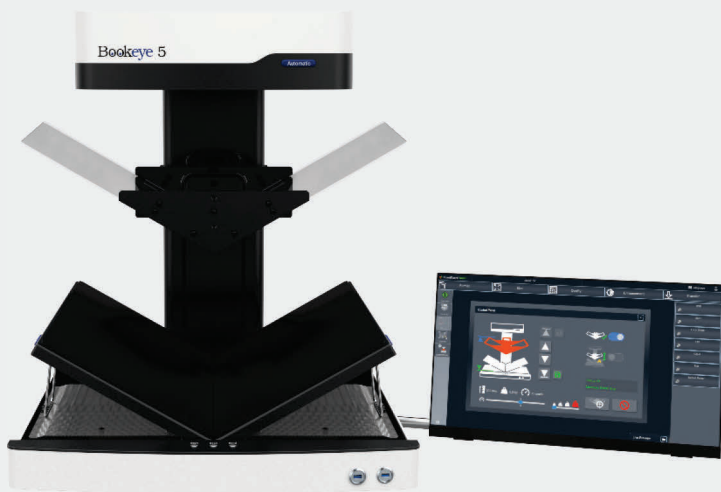

The Bookeye® 5 V2A Automatic with V-shaped book cradle and glass plate.

Highlights that make the Bookeye® 5 V2A Automatic book scanner the right choice for every application

- Large 21" multitouch screen for operation and preview can be mounted to scanner in three different locations.
- Dark mode operation – enhances scan quality through less light reflection and improves operation by reducing eye strain.
- Live Preview – See the document position in live video for correct positioning before scanning.
- Most versatile book cradles, 120°, 180°, shift apart for book bound, shift left and right for optimum position of book.
- Motor driven V-shaped glass plate allows automatic workflow
- Output formats: PDF, PDF/A, JPEG, TIFF, PNM, multipage PDF and TIFF, DICOM and many more.
- Digital color balance, wide color gamut, supports sRGB, Adobe RGB, native RGB.
- FADGI, Metamorfoze Light, ISO 19264-1 compliant.
- Multilingual operation – more than 20 languages available.
- ScanWizard runs on internal touch or on external device through any browser via network.
- Remote maintenance, troubleshooting and firmware updates.

Accessories and Options:

S2N-FSC	Foot Switch for Scanner, hardware accessory for batch scanning.
BSW-P-BE5-01	Batch Scan Wizard Pro License.
SCAN2OCR	Background OCR on scanner.
BE5-V2-A-SP12M	Full Coverage Warranty, up to 5 years of free spare parts and consumables.

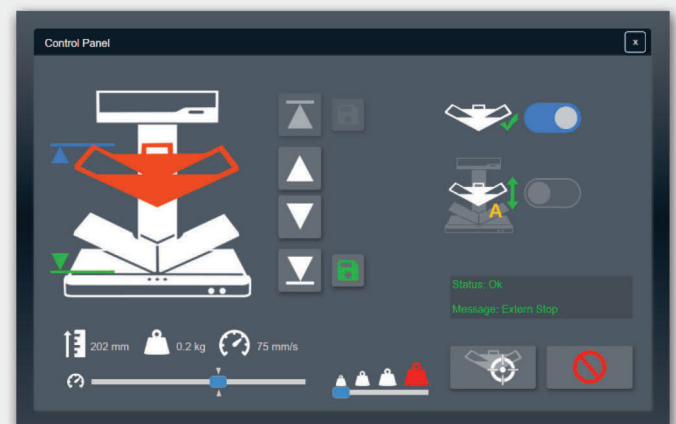

The new control panel with animated function buttons

Bookeye® 5 Markets

- Libraries, Universities, Information Facilities
- Archives, Registries
- Any office environment
- Information Facilities

Bookeye® 5 Applications

- Preserving books and sensitive historical documents
- Scan newspapers, periodicals, catalogs and magazines
- Digitizing files from file folders
- Digitizing bound and stapled documents like contracts, account ledgers and documentation

The Scan2Net® platform is the technological foundation of all WideTEK® and Bookeye® scanners from Image Access. It replaces the proprietary scanner drivers and software that traditional scanners require with the fastest common, nonproprietary inter-device connection available: TCP/IP over Ethernet. With network interface speeds much higher than USB 3.0 or camera link, Scan2Net® devices are able to reach unrivaled performance at extremely low connectivity cost.

Scan2Net® scanners feature a 64 bit Linux based real time operating system, dedicated to scanner specific imaging and mechanical control tasks, maximizing scanning speeds and performance.

Scan2Net® Advantages

- 64 bit Linux based computer, fast and virus protected
- Routable, easy integration into existing network structures
- Only a single IP address is required to run the scanner
- Integration and remote access via the Intranet or even the Internet
- Scans directly to SMB, FTP, hot folders, USB, Email or the Cloud
- All hardware and software built in, no need for external PCs
- Simple, intuitive operation via full HD touchscreen
- Clear menu structure, help files build in
- Multilanguage support, customizable user interface

TECHNICAL DATA

Maximum Scan Area	460 x 620 mm (18 x 24 inch), 14% more than DIN/ISO A2
Scanner Resolution	600 x 600 dpi
Scan Speed	DIN A2+ @ 150 dpi: 0.9 s, DIN A2+ @ 200 dpi: 1.1 s, DIN A2+ @ 300 dpi: 1.6 s, DIN A2+ @ 400 dpi: 2.0 s, DIN A2+ @ 600 dpi: 3.0 s
Color Depth	48 bit color, 16 bit grayscale
Scan Output	24 bit color, 8 bit grayscale, bitonal, enhanced halftone
File Formats	Multipage PDF (PDF/A) and TIFF, JPEG, JPEG 2000, PNM, PNG, BMP, TIFF (Raw, G3, G4, LZW, JPEG), AutoCAD DWF, JBIG, DjVu, DICOM, PCX, Postscript, EPS, raw data and more
ICC Profiles	Embedded for sRGB, Adobe RGB and native. Individual profiling via web based Scan2ICC subscription
Quality	Complies to FADGI *** guidelines, Metamorfoze Light, ISO 19264-1
Camera	CCD line sensor, 22,500 pixels (11,000 scan lines equals to a 245 MPixel matrix camera)
Live Preview Camera	CMOS matrix, area sensor
Light Source	White LEDs, tested according to IEC 62471, no IR/UV emission
Lamp Lifetime	50,000 h typ. Lamps are covered by the Extended Warranty Option
Computer	64 bit Linux, Intel® Core™ i3 generation 8 processor, 240GB SSD, 8 GB memory for extra large jobs
Touchscreen	21" full HD 1920 * 1080 multitouch screen
USB Port	2 x USB 3.0 port, 4 x USB 2.0 port
Interface	1 GBit fast Ethernet with TCP/IP based Scan2Net® interface
Dimension / Weight	H x W x D: 720 x 655 x 645 mm (28 x 26 x 25 inch) / 37 kg (82 lbs.)
Electrical Specification	100-240 V AC, 47 - 63 Hz (external power supply, complies with ECO standard CEC level VI)
Power Consumption	P _(Off) 0.3W / P _(Sleep) 4.6W / P _(Ready) 40W / P _(Active) 110W (43% below ENERGY STAR requirements)
Environment	Operating temperature 5 to 40 °C (40 to 105 °F), relative humidity 20 to 80% (non-condensing)
Noise	< 42 dB(A) (Scanning) / < 33 dB(A) (Standby)
Approvals	IEC/EN 62368-1:2014 Ed.2, AUS/NZL 62368-1:2014 Ed.2 UL 62368-1:2014 Ed.2, CSA 62368-1:2014 Ed.2, RoHS, WEEE



Visit our homepage!



IMAGE ACCESS GMBH

Hatzfelder Str. 161-163
42281 Wuppertal, Germany
Phone: +49 202 27058-0

www.imageaccess.de

IMAGE ACCESS LP

400 N. Belvedere Drive
Gallatin, TN 37066, USA
Phone: +1 (615) 675-4141

www.imageaccess.us